



# Security 1<sup>st</sup> Title

TITLE INSURANCE | CLOSINGS | 1031 EXCHANGE | CONTRACT SERVICING | **SECURITY1STKS.COM**

## FINNEY COUNTY TITLE INSURANCE CHARGES

EFFECTIVE JULY 1, 2016

Amounts Up To	Rate	Amounts Up To	Rate	Amounts Up To	Rate	Amounts Up To	Rate
10,000	195	260,000	810	510,000	1,370	760,000	1,870
20,000	210	270,000	833	520,000	1,390	770,000	1,890
30,000	240	280,000	855	530,000	1,410	780,000	1,910
40,000	270	290,000	878	540,000	1,430	790,000	1,930
50,000	300	300,000	900	550,000	1,450	800,000	1,950
60,000	330	310,000	923	560,000	1,470	810,000	1,970
70,000	360	320,000	945	570,000	1,490	820,000	1,990
80,000	390	330,000	968	580,000	1,510	830,000	2,010
90,000	420	340,000	990	590,000	1,530	840,000	2,030
100,000	450	350,000	1,013	600,000	1,550	850,000	2,050
110,000	473	360,000	1,035	610,000	1,570	860,000	2,070
120,000	495	370,000	1,058	620,000	1,590	870,000	2,090
130,000	518	380,000	1,080	630,000	1,610	880,000	2,110
140,000	540	390,000	1,103	640,000	1,630	890,000	2,130
150,000	563	400,000	1,125	650,000	1,650	900,000	2,150
160,000	585	410,000	1,148	660,000	1,670	910,000	2,170
170,000	608	420,000	1,170	670,000	1,690	920,000	2,190
180,000	630	430,000	1,193	680,000	1,710	930,000	2,210
190,000	653	440,000	1,215	690,000	1,730	940,000	2,230
200,000	675	450,000	1,238	700,000	1,750	950,000	2,250
210,000	698	460,000	1,260	710,000	1,770	960,000	2,270
220,000	720	470,000	1,283	720,000	1,790	970,000	2,290
230,000	743	480,000	1,305	730,000	1,810	980,000	2,310
240,000	765	490,000	1,328	740,000	1,830	990,000	2,330
250,000	788	500,000	1,350	750,000	1,850	1,000,000	2,350

### CLOSING FEES (policy purchase required)

RESIDENTIAL SALE WITH LOAN \$315.00

RESIDENTIAL REFINANCE \$250.00 | RESIDENTIAL SALE WITH CASH \$225.00

#### COMMERCIAL & AGRICULTURAL

\$1.00/1,000 up to 1,000,000 | plus 10¢/1,000 over 1,000,000 (\$400.00 min.)

NON-FINNEY COUNTY TRANSACTIONS \$115 Search Fee

- \* The charges published herein are applicable to normal transactions. In cases involving long and intricate title, more than one chain of title or extraordinary risk, we reserve the right to make additional charges.
- \*\* Multiple lot and new home sales may be subject to special builders and developers rates and are not listed above. Call us for special quotations.
- \*\*\* For residential mortgage policies not exceeding the amount of the owners policy, but issued simultaneously \$125.00.
- \*\*\*\* For policies over \$1,000,000 and simultaneous leasehold policies, charges will be furnished upon request.



# Security 1<sup>st</sup> Title

FINNEY COUNTY | 1135 College Drive, Suite K | Garden City, KS 67846 | (620) 275-6500

## SECTION OF LAND | 640 Acres or one square mile

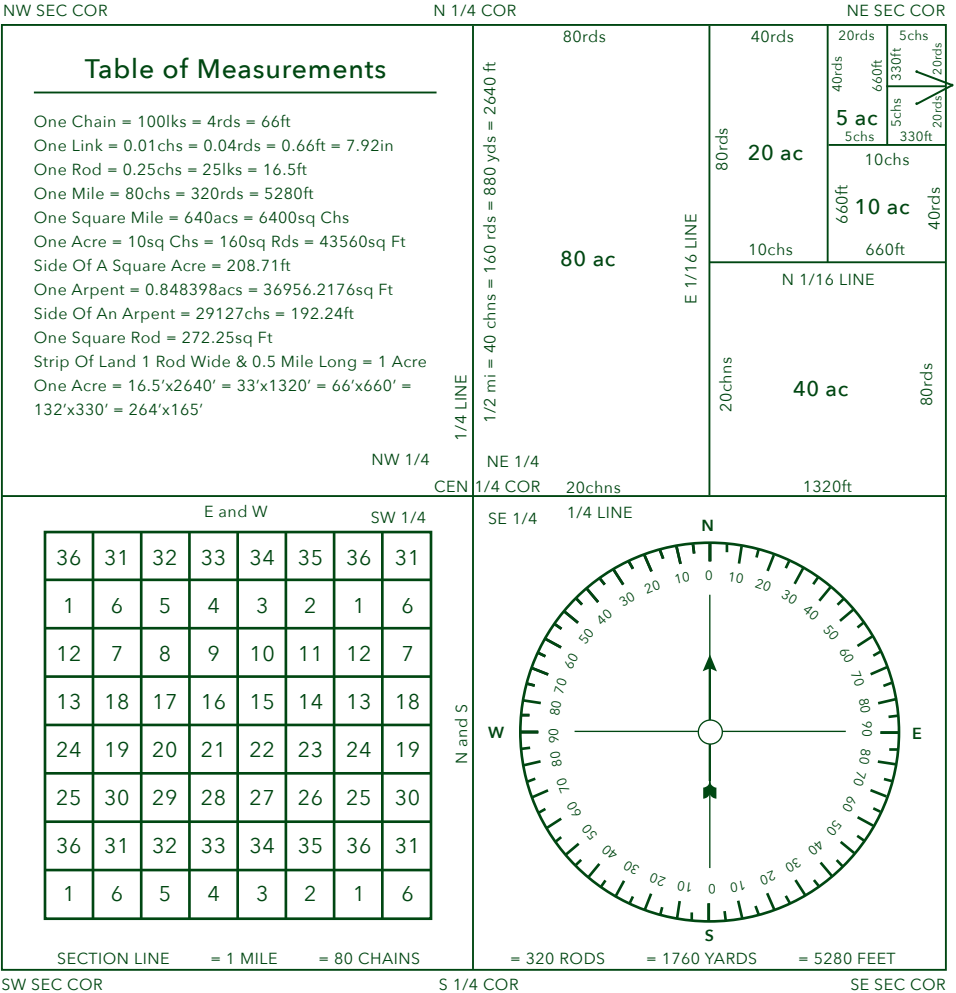

TITLE INSURANCE | CLOSINGS | 1031 EXCHANGE | CONTRACT SERVICING

VISIT US ONLINE AT [WWW.SECURITY1STKS.COM](http://WWW.SECURITY1STKS.COM)